

REQUEST FOR QUOTATION

PROJECT: P20-006: Cottonwood Ranch Broad-Scale Recharge Project Maintenance

LOCATION: Cottonwood Ranch Complex

NEAR: Overton and Elm Creek, Nebraska

CONTACT: Kevin Werbylo, werbylok@headwaterscorp.com
720.524.6115

ATTACHMENT(S):

#1 Location Map, Project Layout & Typical Details

PROJECT DESCRIPTION:

The contractor will be responsible for constructing a small berm and three small ag crossings using approximately 875 cubic yards of material. The contractor will be responsible for seeding the finished project. The contractor may use any machinery necessary to complete the project. An engineer or staff member from the Platte River Recovery Implementation Program (Program) Executive Director's Office (EDO) will provide design point and/or design surface information but will not stake the site. See the attached plan sheets for details.

General notes, specifications and project information are provided below.

- The berm will have an average height of approximately 1' to 2' with a top width of 8' and sides sloped at 6:1 (H:V). The berm will be built in lifts, track compacted and finished with at least 3" of topsoil to promote vegetation establishment (if any clean sand is used during construction).
- The ag crossings will be corrugated metal pipe (CMP) culverts that are topped with fill material. The ag crossings will have a top width of approximately 8-10', wide enough for a pickup to safely cross.
 - The contractor will be responsible for supplying and installing three (3) CMP culverts in the swales with flap gates on the downstream ends. Two culverts will have a diameter of 18" and one will have a diameter of 12", each will have a length of 30'.
 - Supply and install standard hinged flap gates (3/16" mild steel) as supplied by AgriDrain or an approved equal. Heavy duty flap gates cannot be used.

- The borrow area for fill material for the berm and ag crossings will be the denoted area adjacent to the berm. It will be excavated to promote positive drainage from the outlet structure to the northeast, as shown. It can be expanded or narrowed upon approval from engineer, but design finish depths should not be exceeded. The borrow area shall be finished with at least 3” of topsoil (if any clean sand is exposed during grading).
- All disturbed areas (berm, borrow, crossing, etc.) should be seeded with a native prairie mix. Example native seed mix is below or an approved equal. Assume 1 acre of seed will be needed. Drilled seed is preferred. Apply at 8lbs/acre.

Upland Mix: Native Mix #1 by Miller Seed Company or an approved equal.

Common Name	LBS PLS per Acre
Big Bluestem	2.0
Indiangrass	1.5
Little Bluestem	1.5
Sideoats Grama	1.5
Western Wheatgrass	1.0
Switchgrass	0.5

- All other activities of whatever nature (e.g., mobilization, clearing/grubbing grass, etc.) necessary to complete the work are incidental to the total quote amount, and should be built into total quote.

TIMING & SELECTION:

If you wish to submit a quote, please fill out the following page and send a scanned copy to the email address at the top of page 1. Quotes must be received by 10am CT on Monday, May 18, 2020.

Consideration will be given to when the work can get done. It is desired that the work be largely completed before Friday, June 7th, 2020.

There will be no required site visit due. Contractors can go look at the site themselves, if desired. Please

P20-006: Quote Form

Please identify the machinery that will be used and your estimate as to how long it will take to complete the project (in days):

--

Please fill out the 'Unit Bid Price' and 'Bid Price' values below:

Item No	Description	Unit	Bid Price
1	Earthwork	LS	
2	Seeding	LS	
3	Culverts & Flap Gates	LS	

TOTAL QUOTE PRICE: _____

WORK DATE(S): _____

SUBMITTED BY: _____
(Company)

(Individual – Print)

(Sign/Date)

748 RD

LOCATION
OF WORK

ACCESS THROUGH
GATE

PIPELINE OUTLET

PETERSON DRAIN

COTTONWOOD RANCH LANDS

COTTONWOOD RANCH LANDS

H RD

747 RD

TO US HWY 183

I RD

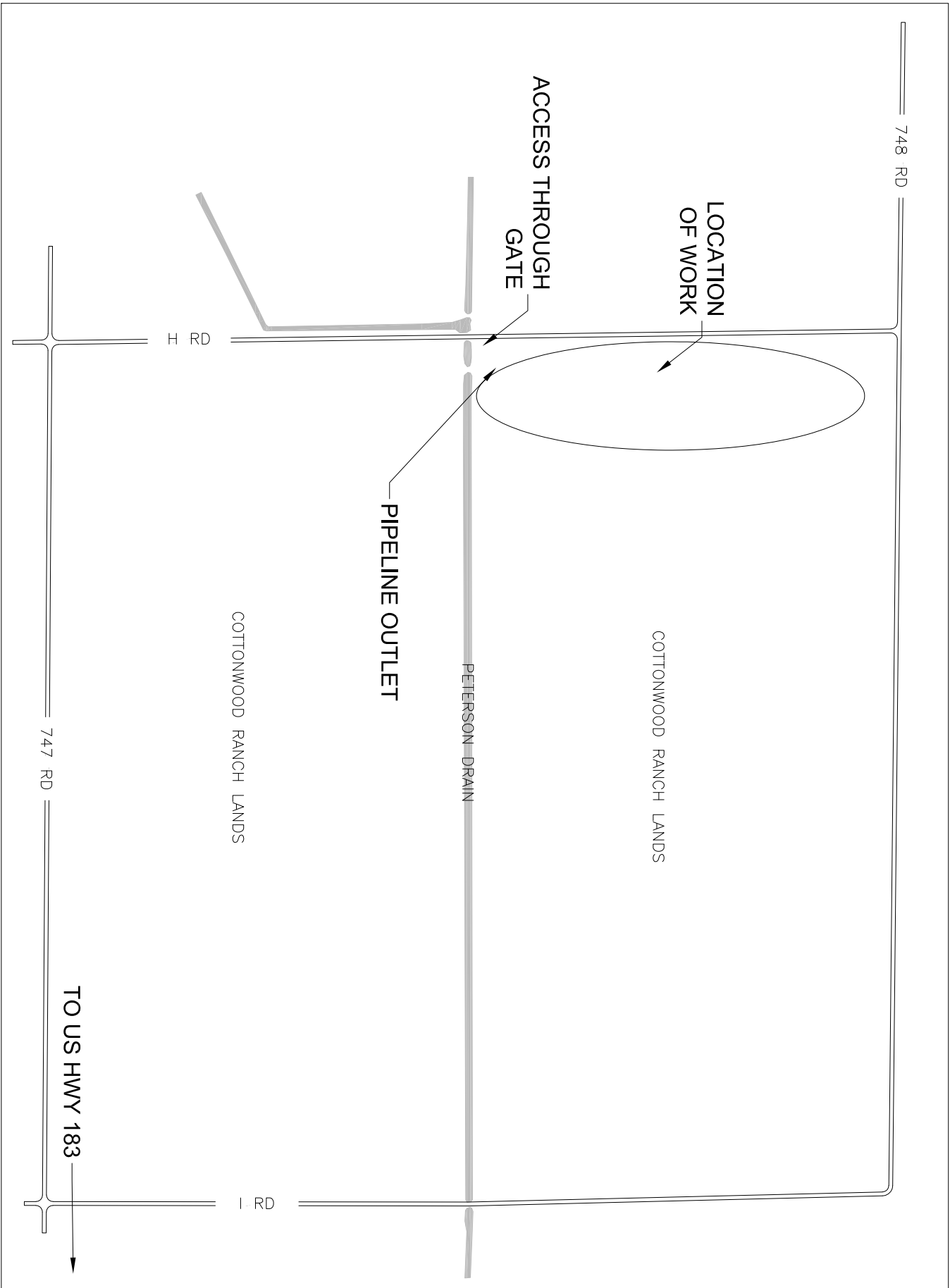

CONSTRUCTION NOTES:

EXCAVATE SWALE AND PLACE MATERIAL TO FORM BERM. TRACK COMPACT BERM.

TOP WIDTH OF BERM AT 8' AND SIDE SLOPES AT 6H:1V.

FINISH EXCAVATION AND BERM WITH SEED.

FINISHED 6" CONTOURS ARE SHOWN.

CAN EXPAND OR REDUCE WIDTH OF SWALE TO INCREASE OR REDUCE VOLUME OF MATERIAL. CANNOT EXCAVATE BEYOND DEPTHS SHOWN.

BERM AND SWALE AREA IS ABOUT 0.92 ACRES.

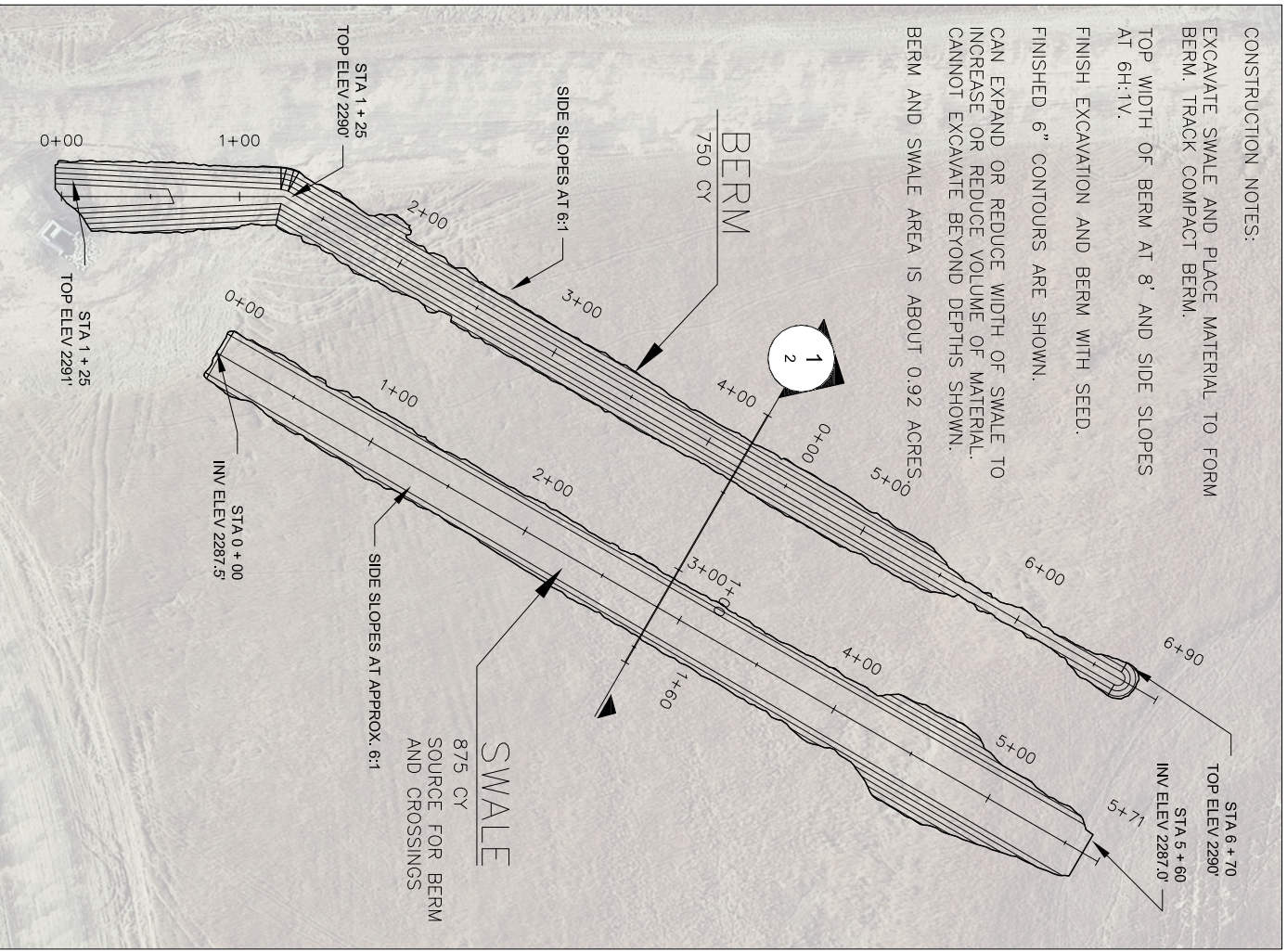

CONSTRUCTION NOTES:

EXCAVATE SWALE AND PLACE MATERIAL OVERTOP OF CULVERTS AS SHOWN.

PLACE CULVERTS ALONG FLOWPATH. AND PLACE FLAP GATES ON WEST ENDS OF CULVERTS.

CULVERTS SUPPLIED BY CONTRACTOR, INSTALLED BY CONTRACTOR.

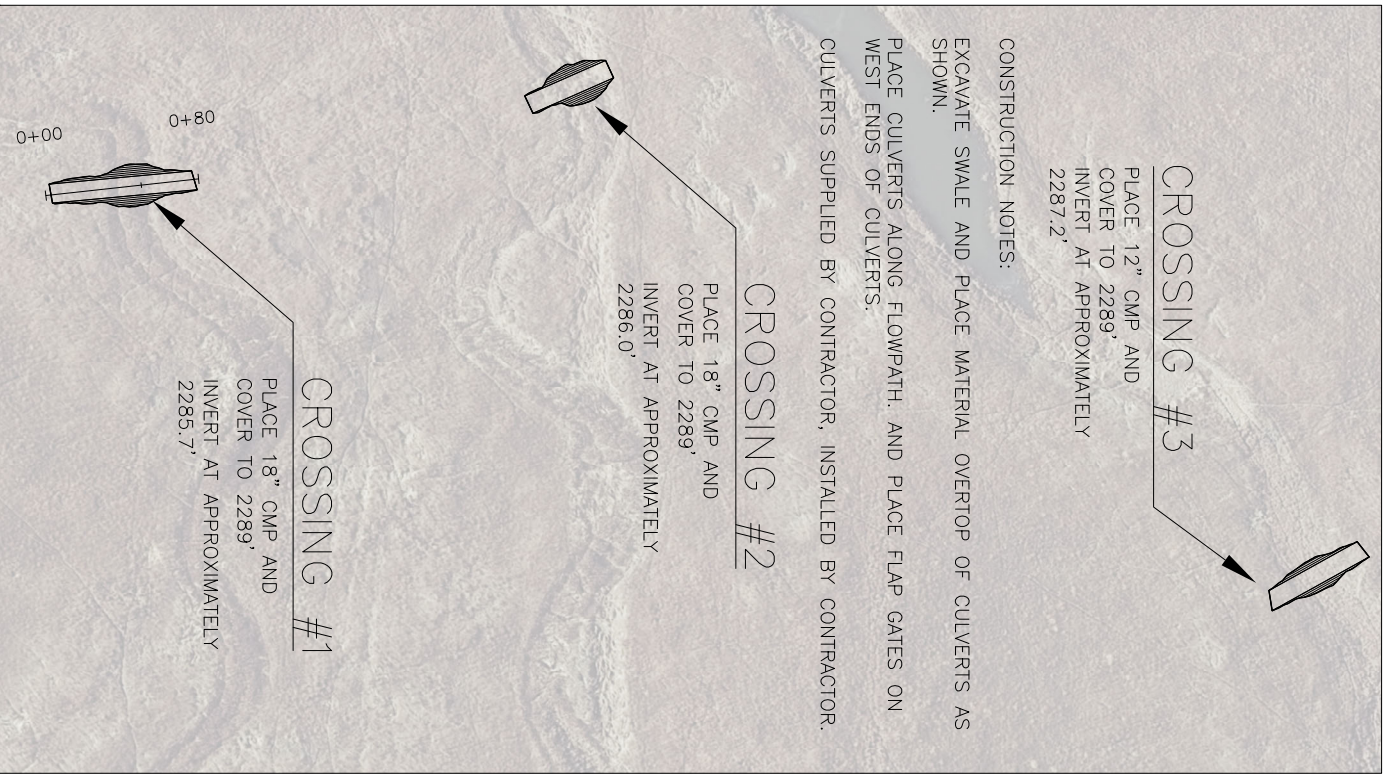

PLATTE RIVER RECOVERY PROGRAM

PLATTE RIVER RECOVERY IMPLEMENTATION PROGRAM



Scale: 1" = 100'

Sheet 1 of 2

BERM ALIGNMENT

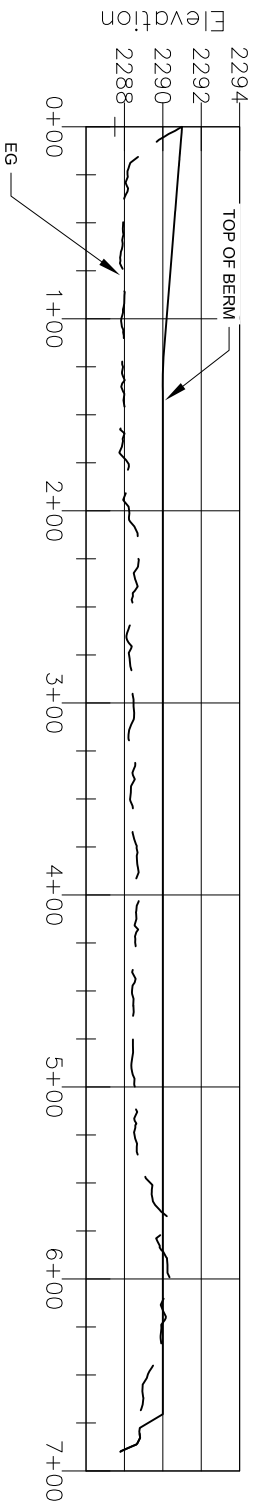

BORROW/SWALE ALIGNMENT

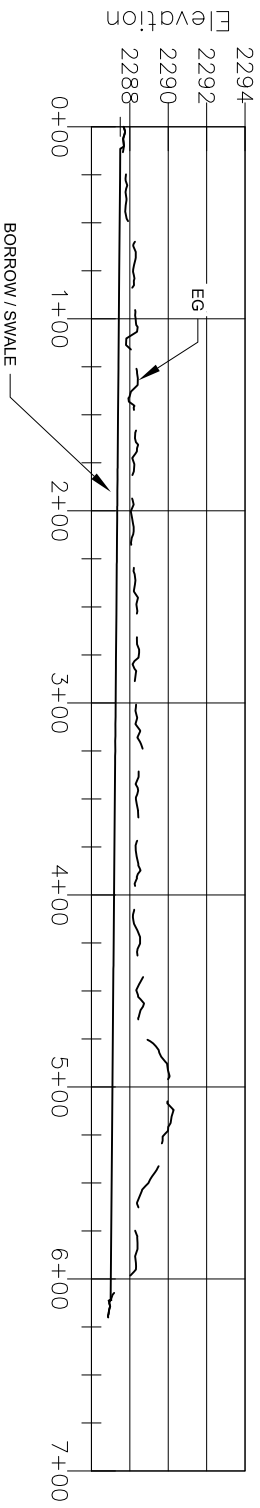

BERM & BORROW SECTION

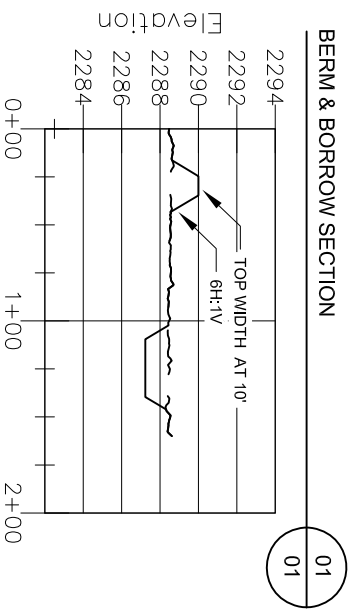

AG CROSSING ALIGNMENT

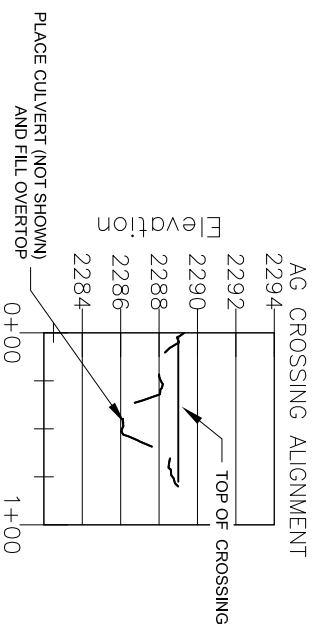

**PLATTE RIVER RECOVERY
IMPLEMENTATION PROGRAM**



Scale: 1" = 100'